

1275 - Green

Code: 428605-00

GENERAL INFORMATION

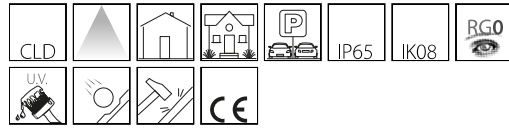

Article	1275 - Green
Code	428605-00

DIMENSIONS AND WEIGHT

Length (mm)	177 mm
Width (mm)	275 mm
Height (mm)	177 mm
Weight (Kg)	0.92 kg

ELECTRICAL CHARACTERISTICS AND CONTROLS

Voltage type	AC
Min Voltage (V)	220 V
Max Voltage (V)	240 V
Min Frequency (Hz)	50 Hz
Max Frequency (Hz)	60 Hz
Frequency (Hz)	50 Hz
Wiring name	CLD
Power factor	≥ 0.9
Insulation class	Class I
Controllability	None



1275 Green



1275 - Green

Code: 428605-00

PHOTOMETRIC DATA

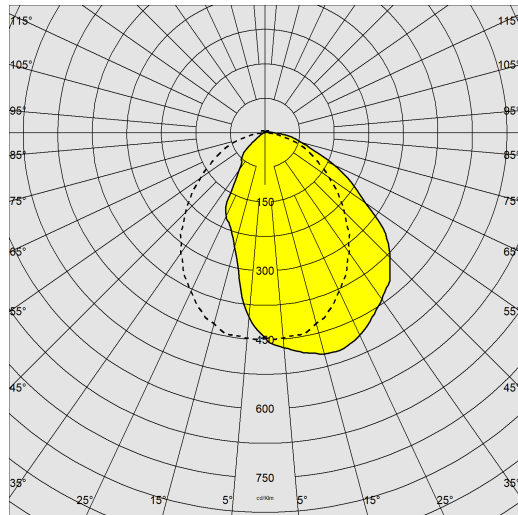

Lighting source	LED
CRI	80
Luminous flux (output) (lm)	1300 lm
Power absorption (total) (W)	9 W
CCT	4000 K
Luminous efficacy (lm/W)	144 lm/W
LED flux maintenance	50000 hr, L 70, B 50

MECHANICAL CHARACTERISTICS

Impact resistance rating (IK)	IK08
IP	65



1275 - Green

Code: 428605-00

MATERIALS AND COLOURS

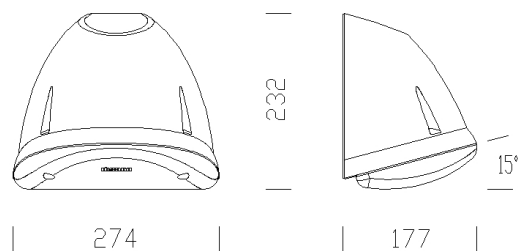

Housing	in fibreglass nylon, shatterproof, UV stabilised.
Optics	anodised and polished 99.85 aluminium.
Diffuser	in anti-glare matt polycarbonate, shatterproof and V2 self-extinguishing, UV stabilised, anti-yellowing, externally smooth and dustproof.
Pole connection	can be installed on pole with acc. 502/503
Colour	Grey
Equipment	<ul style="list-style-type: none"> - complete with fixing plate. - EPDM foam bowl gasket. - external screws in galvanised stainless steel with black OR.

STANDARDS AND COMPLIANCE

Photobiological safety class	RG0
Markings and tests	CE
Reference standards	EN60598-1. With degree of protection according to EN60529.
Energy Label	C

DOWNLOAD

MOUNTS

[AssemblyInstructions green 09-22.pdf](#)

DESIGNS

[TechnicalDrawing 1285.dxf](#)



WARRANTY

After sales warranty	3 yr
----------------------	------

1275 - Green

Code: 428605-00

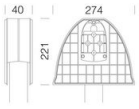

503 Double connection for \varnothing 60

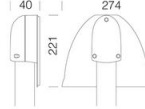

502 Single connection for \varnothing 60



5 Fibreglass pole