

1661 - Microfloor LED - 230V

Code: 530816-00

GENERAL INFORMATION



Article	1661 - Microfloor LED - 230V
Code	530816-00

DIMENSIONS AND WEIGHT

Height (mm)	86 mm
Diameter (Ø) (mm)	120 mm
Weight (Kg)	0.4 kg

ELECTRICAL CHARACTERISTICS AND CONTROLS

Voltage type	AC
Min Voltage (V)	220 V
Max Voltage (V)	240 V
Min Frequency (Hz)	50 Hz
Max Frequency (Hz)	60 Hz
Frequency (Hz)	50 Hz
Wiring name	CLD
Power factor	≥0.95
Insulation class	Class I
Controllability	None



1661 Microfloor LED - 230B



1661 - Microfloor LED - 230V

Code: 530816-00

PHOTOMETRIC DATA

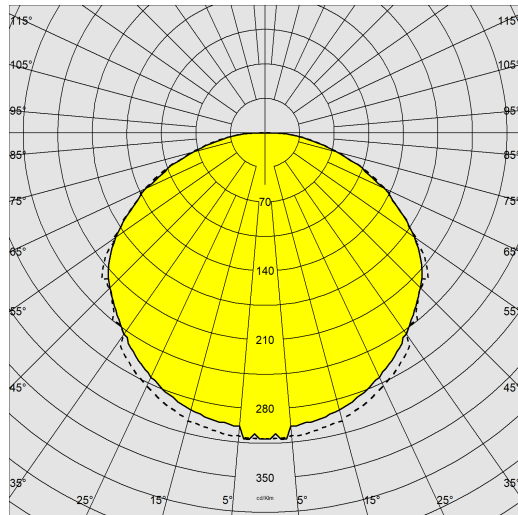

Lighting source	LED
CRI	80
Luminous flux (output) (lm)	43 lm
Power absorption (total) (W)	1 W
CCT	4000 K
Luminous efficacy (lm/W)	43 lm/W
Beam angle	120 °
LED flux maintenance	50000 hr, L 70, B 50

MECHANICAL CHARACTERISTICS

Impact resistance rating (IK)	IK08
Max load	2000 kg
Walkover	True
Driveover	True
IP	67

1661 - Microfloor LED - 230V

Code: 530816-00

MATERIALS AND COLOURS

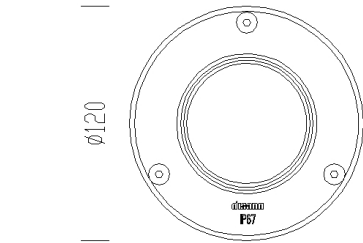
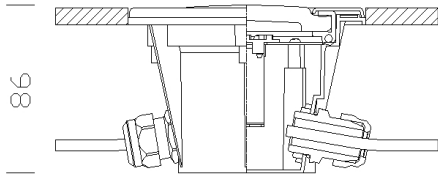

Housing	in fibreglass nylon, frame in AISI 316 stainless steel.
Diffuser	tempered glass, resistant to thermal shock and impact (UNI EN 12150-1:2001).
Colour	Stainless steel
Equipment	silicone and EPDM rubber sealing gasket.
	driveway lamp. Keep clear.

STANDARDS AND COMPLIANCE

Photobiological safety class	RG0
Markings and tests	CE
Reference standards	EN60598-1. They have a degree of protection according to the EN60529 standard.
Energy Label	D

DOWNLOAD

WARRANTY

MOUNTS

[AssemblyInstructions microfloor 10-22.pdf](#)

DESIGNS

[TechnicalDrawing 1650 microfloor.dxf](#)

After sales warranty	3 yr
----------------------	------



1661 - Microfloor LED - 230V

Code: 530816-00

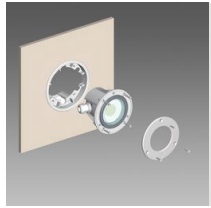

314 Wall frame

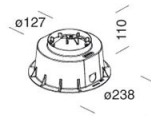

313 Outer shell